

- 1A MARK ALBERT & ERIKA MARTIN 1202/335, 1504/39
- 1B CYR POTATO CORP. 659/221
- 2 LILLIAN ROY 671/136
- 2A BETTY ANN ROY Co. 1317/271
- 2B MRS. LILLIAN ROY
- 3 BETTY ANN ROY Co. 1317/271
- 5 GARY THIBEAULT 442/145, 1119/70
- 6A JUSTIN GUERRETTE 1897/221
- 6B REV. CHARLES SWERON COUNCIL 1268/331
- 8A THOMAS & PAULINE COLLIN 625/255 & 681/224
- 8B W. & N. HOLLAND, L.L.C. 1094/257
- 8C THOMAS & PAULINE COLLIN 1733/272
- 8D WILLIAM & NANCY HOLLAND 1041/263
- 10 STEVEN & BRENDA BOURGOIN 1677/4
- 11A JAMES J. & ROLANDE CHASSE 1166/189
- 11B DONALD & LORETTE CASTONGUAY 401/200
- 11C GLENN & PATRICIA VOISINE 518/38
- 15A PHILIP & SHERENE PELLETIER 494/288, 1485/57 TRUSTEES 1677/11
- 15B DANIEL M. PELLETIER 1708/67

- 41 MICHAEL, LYNDY & ANNA OUELLETTE 1934/237
- 42 DEBRA MATTIOLI 1616/297
- 43 TROY & ALEXANDRA DESJARDINS 2000/325
- 44 DAVID & ROSE BOURCOIN 466/183, 834/54

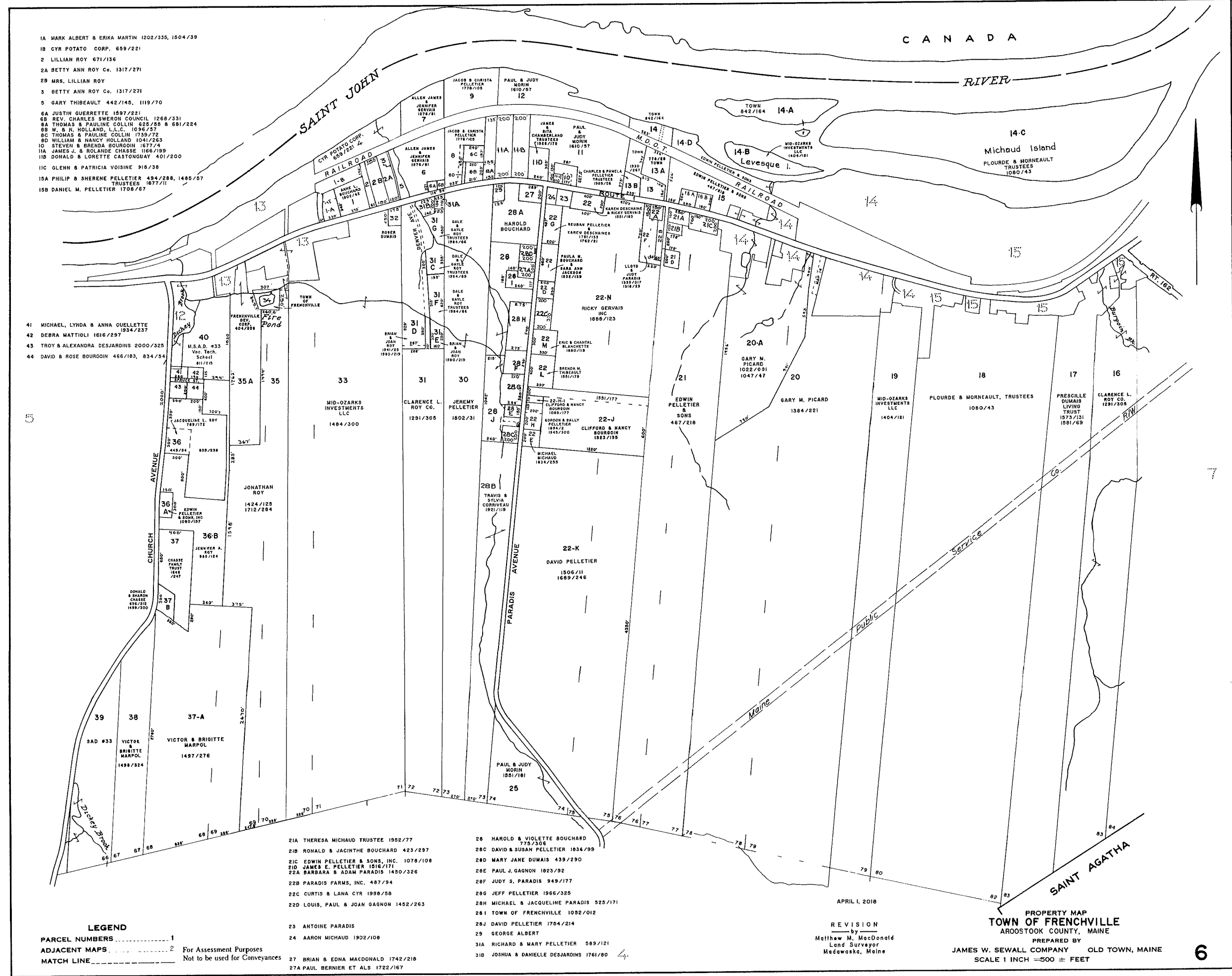

LEGEND

PARCEL NUMBERS 1

ADJACENT MAPS 2

MATCH LINE 3

For Assessment Purposes

Not to be used for Conveyances

- 21A THERESA MICHAUD TRUSTEE 1952/77
- 21B RONALD & JACINTHE BOUCHARD 423/297
- 21C EDWIN PELLETIER & SONS, INC. 1078/108
- 21D JAMES E. PELLETIER 1516/171
- 22A BARBARA & ADAM PARADIS 1450/326
- 22B PARADIS FARMS, INC. 487/94
- 22C CURTIS & LANA CYR 1998/58
- 22D LOUIS, PAUL & JOAN GAGNON 1452/263
- 23 ANTOINE PARADIS
- 24 AARON MICHAUD 1902/108
- 25 BRIAN & EDNA MACDONALD 1742/218
- 27A PAUL BERNIER ET ALS 1722/167
- 28 HAROLD & VIOLETTE BOUCHARD 773/308
- 28C DAVID & SUSAN PELLETIER 1834/99
- 28D MARY JANE DUMAIS 439/290
- 28E PAUL J. GAGNON 1823/92
- 28F JUDY S. PARADIS 949/177
- 28G JEFF PELLETIER 1966/325
- 28H MICHAEL & JACQUELINE PARADIS 525/171
- 28I TOWN OF FRENCHVILLE 1052/012
- 28J DAVID PELLETIER 1754/214
- 29 GEORGE ALBERT
- 31A RICHARD & MARY PELLETIER 589/121
- 31B JOSHUA & DANIELLE DESJARDINS 1761/80

APRIL 1, 2018

REVISION
by
Matthew M. MacDonald
Land Surveyor
Madawaska, Maine

PROPERTY MAP
TOWN OF FRENCHVILLE
AROOSTOOK COUNTY, MAINE
PREPARED BY
JAMES W. SEWALL COMPANY OLD TOWN, MAINE
SCALE 1 INCH = 500 ± FEET