

SAINTE JOHN RIVER

- 1 JERRY & JUDY LAVOIE 808/23
- 4 MATTHEW FONGEMIE 1915/60
- 5 CARLOS & PEGGY SOUSA 1926/318
- 6 LINDA PICARD 1267/302, 1375/298
- 7 BRENTON DEPREY 1503/248
- 8 JEAN GUY CHASSE 546/152, 1091/44
- 9 FRANK MARTIN 434/144
- 9A JUSTIN GUERRETTE 1336/245
- 10 ANTONIO SOTO 1844/130
- 11 DANIEL & JUNE COLLIN 930/81
- 12 PAUL & NORA MICHAUD 936/332
- 13 PAUL & NORA MICHAUD 936/332 1190/173
- 14 MICHAEL & LISA MICHAUD 1740/92
- 15 FRANK & JOYCE MARTIN 1041/151
- 16 DALE B. & GAYLE ROY TRUSTEES 1984/81

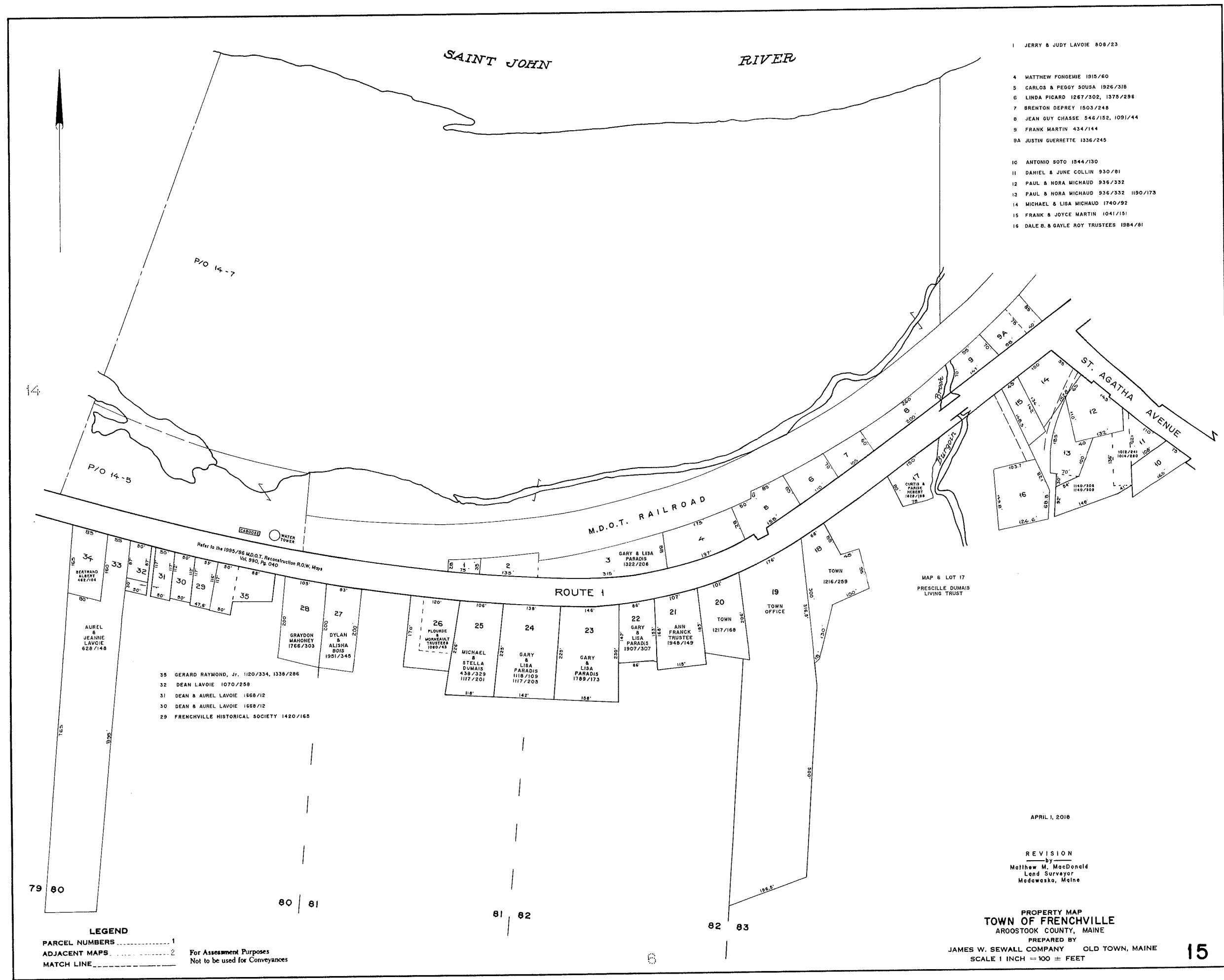

Refer to the 1985/86 M.D.O.T. Reconstruction R.O.W. Maps
Vol. 890, Pg. 040

34 GERARD ALBERT 482/104

AUREL & JEANNE LAVOIE 628/148

35 GERARD RAYMOND, Jr. 1120/334, 1338/286

32 DEAN LAVOIE 1070/259

31 DEAN & AUREL LAVOIE 1668/12

30 DEAN & AUREL LAVOIE 1668/12

29 FRENCHVILLE HISTORICAL SOCIETY 1420/165

28 GRAYDON MAHONEY 1766/303

27 DYLAN & ALISHA BOIS 1951/345

26 FLORENCE & MONTEVAULT TRUSTEES 1060/743

25 MICHAEL & STELLA DUMAIS 438/329, 1117/201

24 GARY & LISA PARADIS 1116/109, 1117/205

23 GARY & LISA PARADIS 1789/173

22 GARY & LISA PARADIS 1907/307

21 ANN FRANCK TRUSTEE 1948/149

20 TOWN 1217/168

19 TOWN OFFICE 1216/269

LEGEND

PARCEL NUMBERS 1

ADJACENT MAPS 2

MATCH LINE 3

For Assessment Purposes
Not to be used for Conveyances

MAP & LOT 17
PRESCILLE DUMAIS
LIVING TRUST

APRIL 1, 2018

REVISION
by
Matthew M. MacDonald
Land Surveyor
Madawaska, Maine

PROPERTY MAP
TOWN OF FRENCHVILLE
AROOSTOOK COUNTY, MAINE
PREPARED BY
JAMES W. SEWALL COMPANY OLD TOWN, MAINE
SCALE 1 INCH = 100 ± FEET